

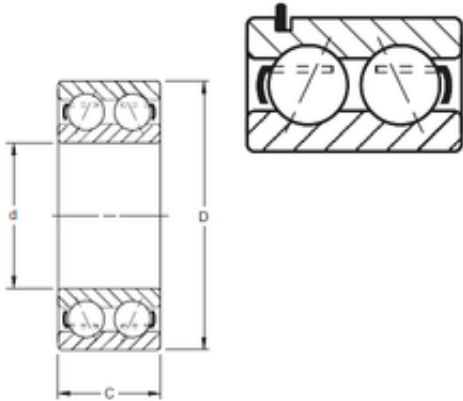

# PARKER PUMP LTD

## TIMKEN 5310KG Angular Contact Ball Bearings

Bearing No. 5310KG



5310KG Bearing 2D drawings and 3D CAD models

|                               |                 |
|-------------------------------|-----------------|
| Size                          | 50x110x44.45 mm |
| Bore Diameter                 | 50 mm           |
| Outer Diameter                | 110 mm          |
| Width                         | 44,45 mm        |
| d                             | 50 mm           |
| D                             | 110 mm          |
| C                             | 44,45 mm        |
| Angle ( )                     | 30 °            |
| Weight                        | 1,932 Kg        |
| Basic dynamic load rating (C) | 126 kN          |